

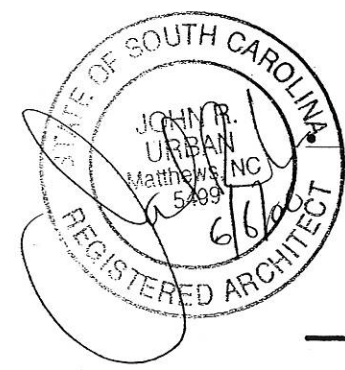

1242 Mann Drive, Suite 200
 Matthews, North Carolina 28105
 www.urbanarchitecturalgroup.com
 P: 704.841.1899 F: 704.841.8440

These drawings are an instrument of service provided by Urban Architectural Group, PA.
 © 2006 URBAN ARCHITECTURAL GROUP P.A.
 All rights reserved. Unauthorized reproduction prohibited.



LAKE SHORE TOWN HOMES
 TEGA CAY, SC

FOUNDATION PLANS
 for
 UNITS B & C

DATE DRAWN:	5 JUNE 2006
PROJECT NO.:	2530
ISSUED FOR:	PERMIT & CONSTRUCTION
	5 JUNE 2006

FOUNDATION NOTES

- Footings designed for 2,000 psf min. soil bearing capacity. All concrete to be 3,000 psi w.s.p.
- Plumbing Contractor shall field verify all plumbing locations prior to work.
- Slab plate at exterior walls shall be anchored to the foundation with anchor bolts spaced a maximum of 6 feet on center. Anchor bolts shall also be located within 12 inches from the ends of each plate section. Bolts shall be at least 1/2 inch in diameter and shall extend a minimum of 7 inches into masonry or concrete. Interior bearing wall sole plates on monolithic slab foundations shall be positively anchored with approved fasteners.
- Bora-Care termite treatment to be applied to interior & exterior framing materials 2'-0" A.F.F. on 1st floor only.
- Foundation is designed for trusses.
- Provide Support for porch and steps to grade as required.
- 5" Footing extension required for brick or stone option.

STRUCTURAL ELEMENTS	
#	DESCRIPTION:
1	3'-0" x 3'-0" x 1'-0" DEEP FOOTING w/ 4-#4 BOTTOM EACH WAY, 3000 PSI NORMAL WEIGHT CONCRETE.
2	2'-6" x 2'-6" x 1'-0" DEEP FOOTING w/ 3-#4 @ BOTTOM, EACH WAY, 3000 PSI, NORMAL WT CONC.

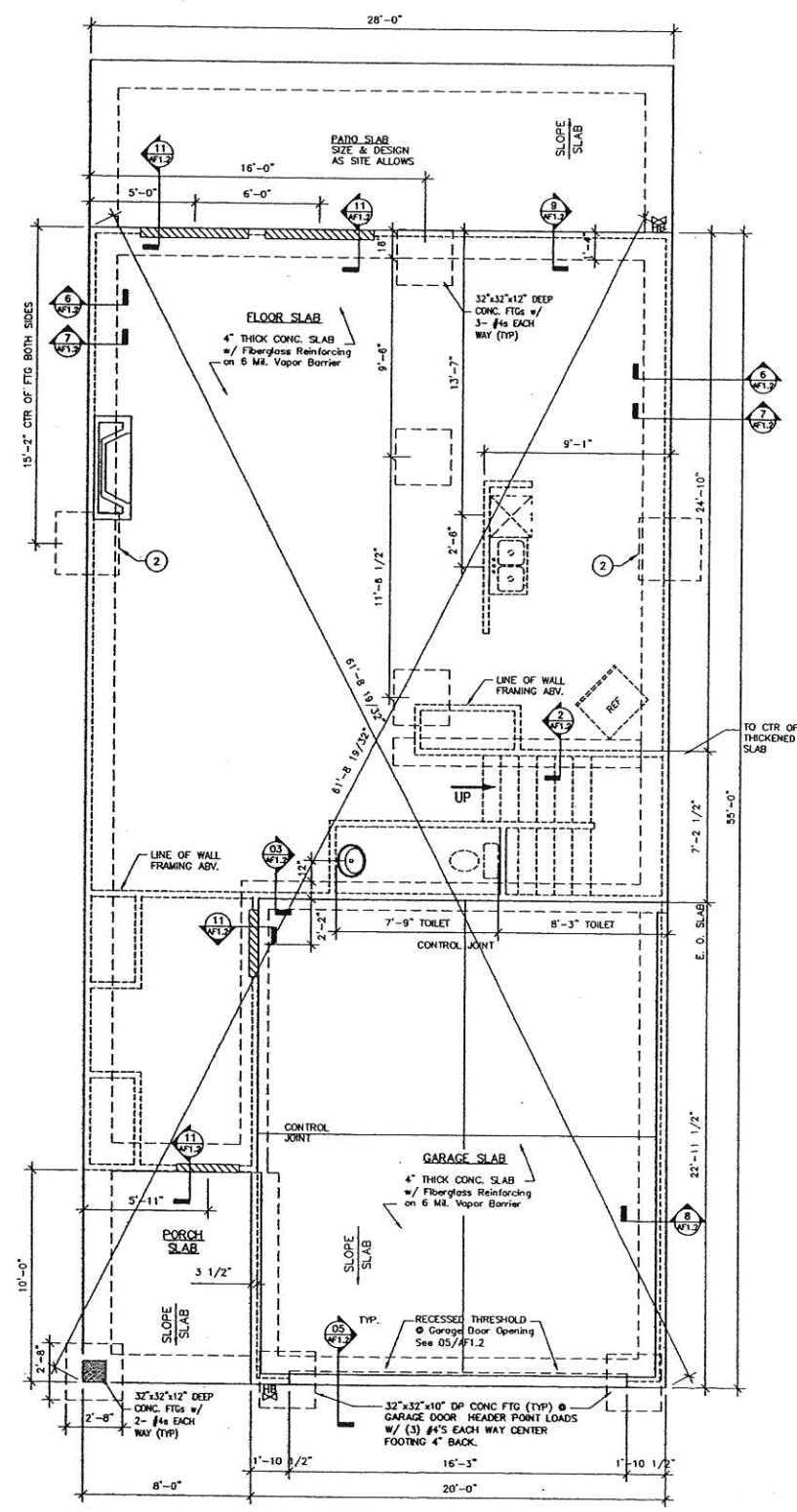
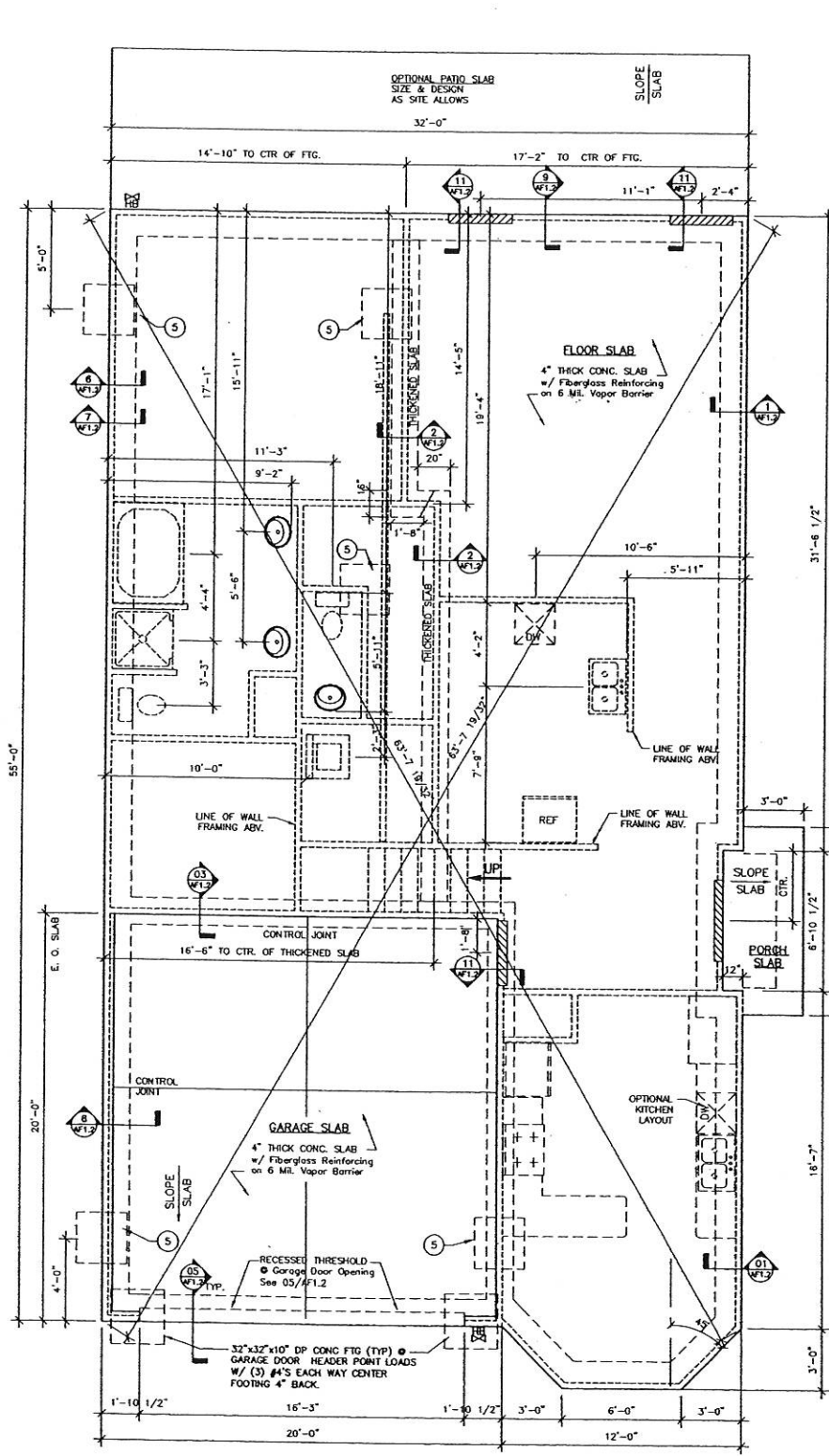

NOT USED

AF1.1